

NOTES:

1. ALL COORDINATES ARE APPROXIMATE. DETAILED SURVEY TO BE DONE IN FUTURE IF NEEDED. CO-ORDINATES TO BE CONFIRMED ON SITE.
2. ALL STORMWATER DISCHARGE POINTS HAVE BEEN ESTIMATED FROM CONTOURS GENERATED FROM GOOGLE EARTH, DUE TO NO SURVEY DATA. ALL DISCHARGE POINTS ARE TO BE VERIFIED BY THE CONTRACTOR ON SITE, PRIOR TO CONSTRUCTION STARTING.

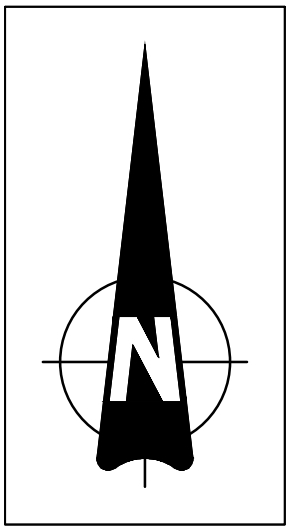

NO	DATE	REVISION	DRAWN
A	2022-10-03	ISSUED FOR TENDER PURPOSE	AC

LEGEND:

PROPOSED STORMWATER

NOTES:

1. NEW V-DRAIN POSITIONS TO REMAIN THE SAME AS THE EXISTING DRAINS

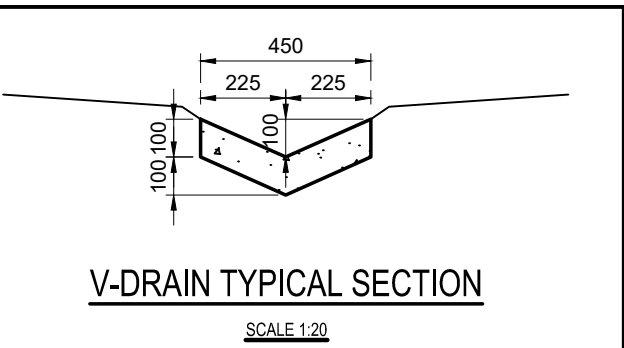
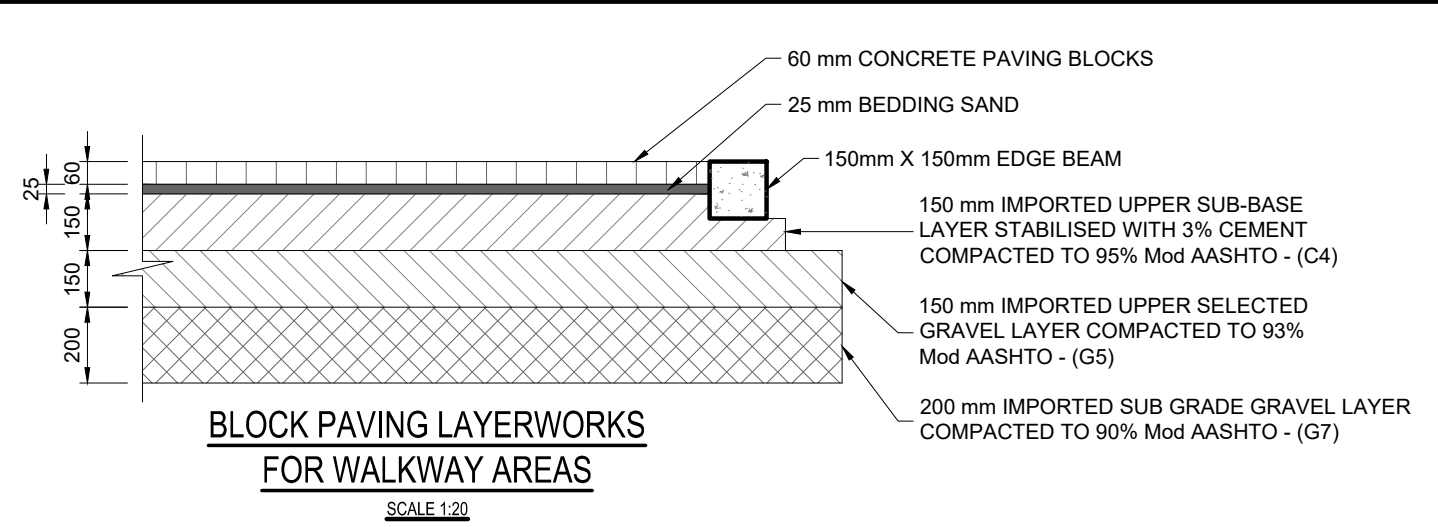
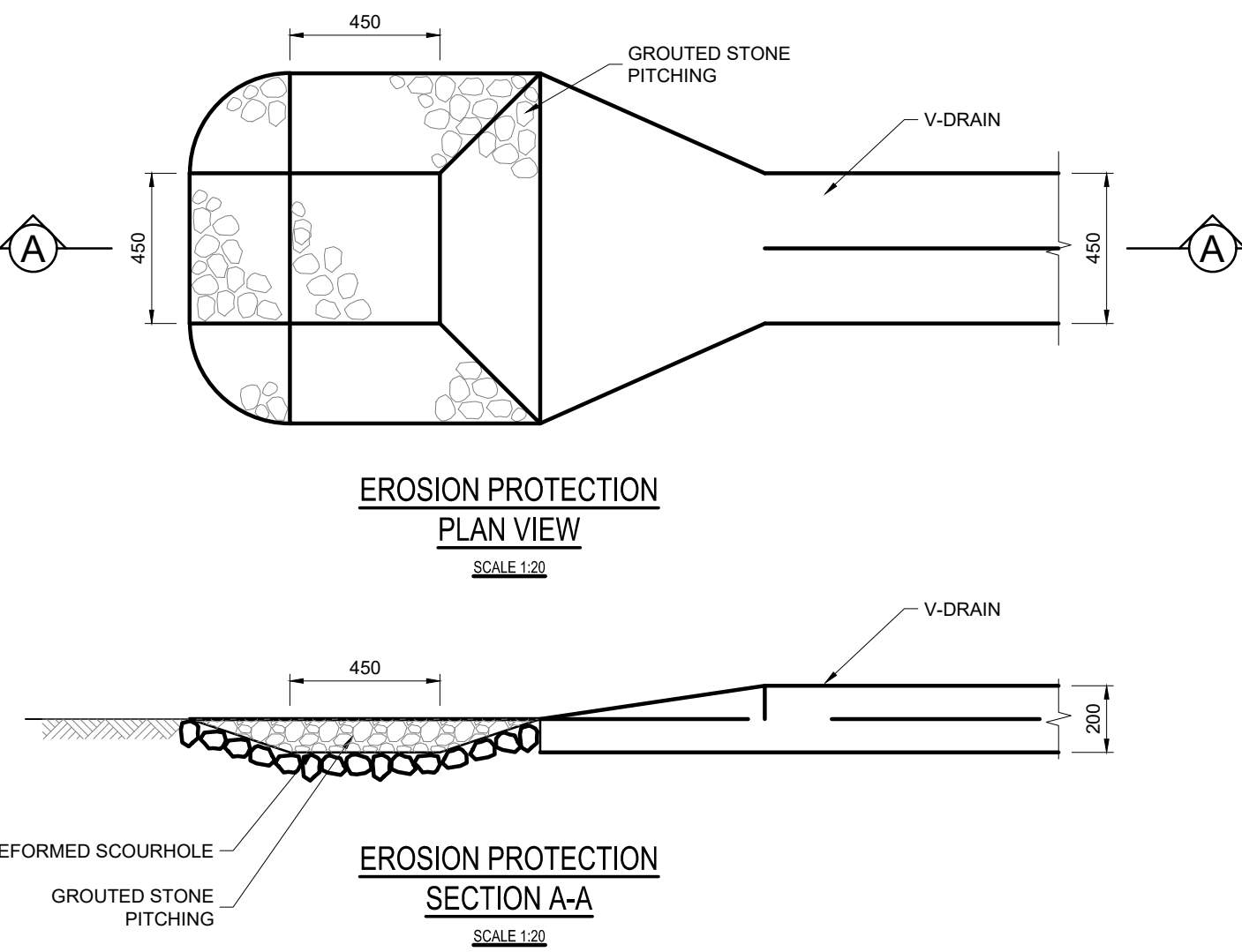
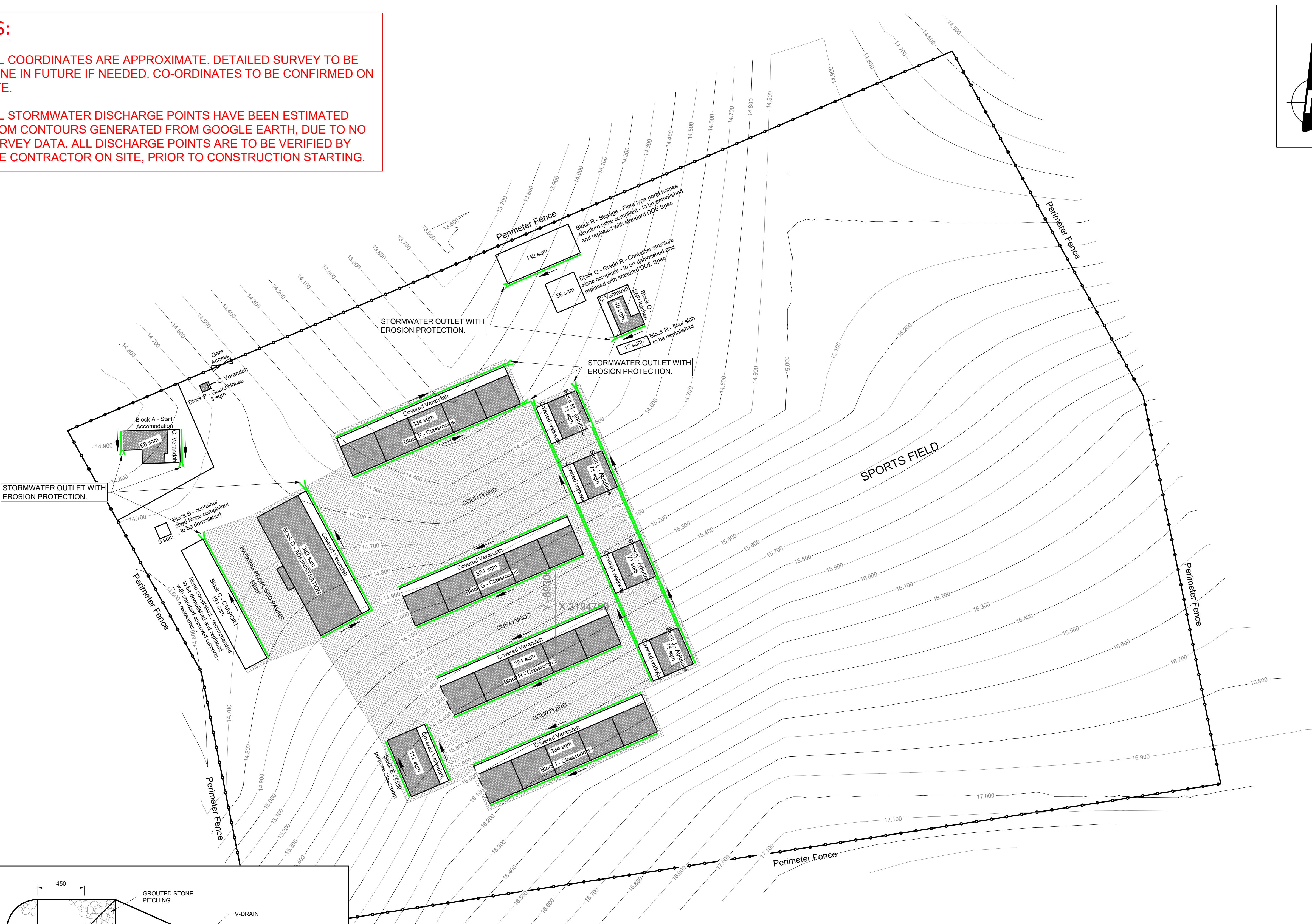

GladAfrica
Consulting Engineers

APPROVAL STATUS:

FOR INFORMATION: ☐ PRELIMINARY, ☐ DESIGN, ☒ TENDER, ☐ CONSTRUCTION, ☐ AS BUILT

NAME: **A. PADAYACHEE**
PR. NO: **2018300272**
DATE: **2022-10-03**
SIGNATURE:

CLIENT

 **education**
Department:
Education
PROVINCE OF KWAZULU-NATAL

IMPLEMENTING AGENT

 **DBSA**
Development Bank
of Southern Africa

CONSULTANT

 **GladAfrica**
Consulting Engineering

Gauteng Office (Head Office)
GladAfrica House, Hertford Office Park
90 Bekker Road, Vorna Valley, Midrand, 1686
P.O. Box 6723 Halfway House 1685
Tel: +27 11 312 2537/2584
Fax: +27 11 805 1950
www.gladfrica.com Contact us gladfrica@gladfrica.com

COPY RIGHT RESERVED
THE DUPLICATION OF THIS DRAWING IS
STRICTLY PROHIBITED

SHEET SIZE	SCALE	STATUS LEGEND	
A1	1:500	I = INFORMATION P = PRELIMINARY T = TENDER	D = DESIGN C = CONSTRUCTION AB = AS BUILT
	NAME	SIGNATURE	PROFESSIONAL.REG
DRAWN	A. CLAASE		
DESIGNED	A. NGOMANI		
CHECKED	A. PADAYACHEE		2018300272

PROJECT DESCRIPTION

PROJECT: **KZN D.O.E INFRASTRUCTURE DEVELOPMENT AND MAINTENANCE PROGRAMME**

DRAWING TITLE: **ILEMBE PRIMARY SCHOOL STORMWATER CHANNEL LAYOUT**

DISCIPLINE	DRAWING NUMBER	STATUS	REVISION
CIVIL	GAIC124-C-SW-004	T	A